

**Packaging Information**

**Mechanical Dimensions**  
**For Discrete**

**ITO220AB**

**Unit: mm**

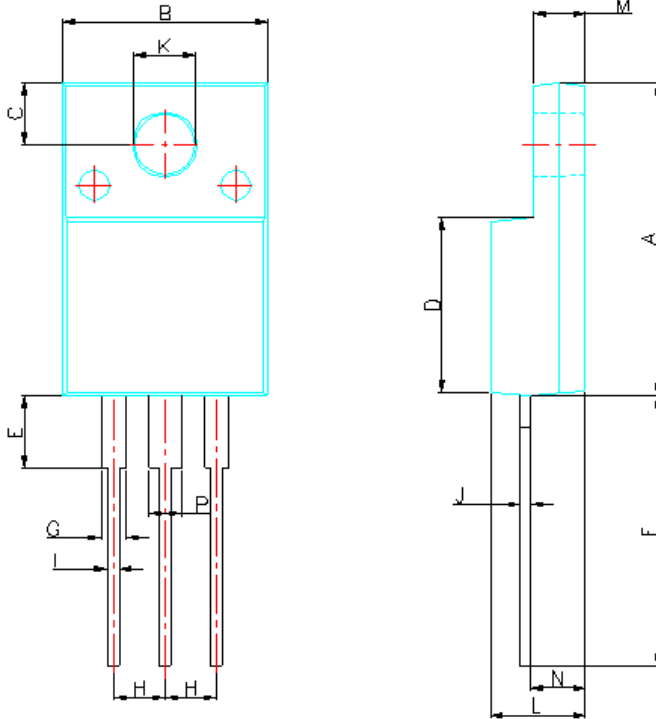

ITO-220AB (WB)		
DIM.	MIN.	MAX.
A	14.95	15.95
B	10.00	10.40
C	2.76	3.36
D	8.50	8.80
E	3.30	3.90
F	13.0	13.7
G	1.15	1.70
H	2.40	2.70
I	0.50	0.80
J	0.45	0.70
K	3.00	3.30
L	4.46	4.87
M	2.48	2.80
N	2.50	2.80
P	1.50	1.90
All Dimensions in millimeter		